

PERSPECTIVE
BROODER HOUSE
LAYING HOUSE
CHICKEN HOUSE-BANTAMS
PIGEON HOUSE

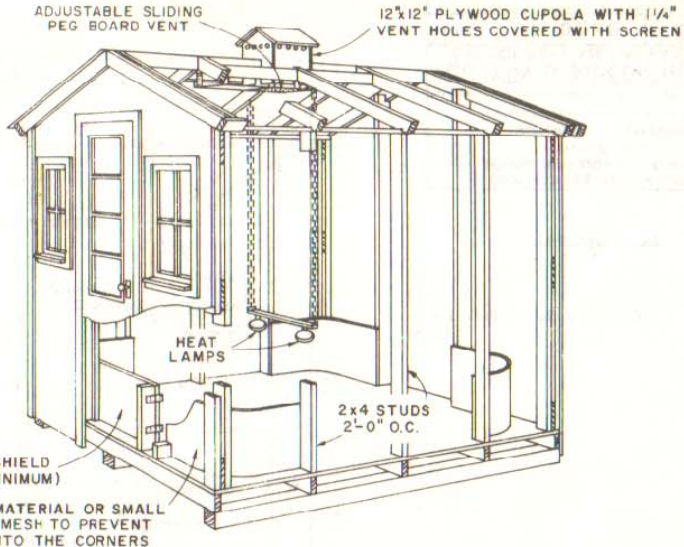

CUTAWAY VIEW
OF 8x8' BROODER HOUSE

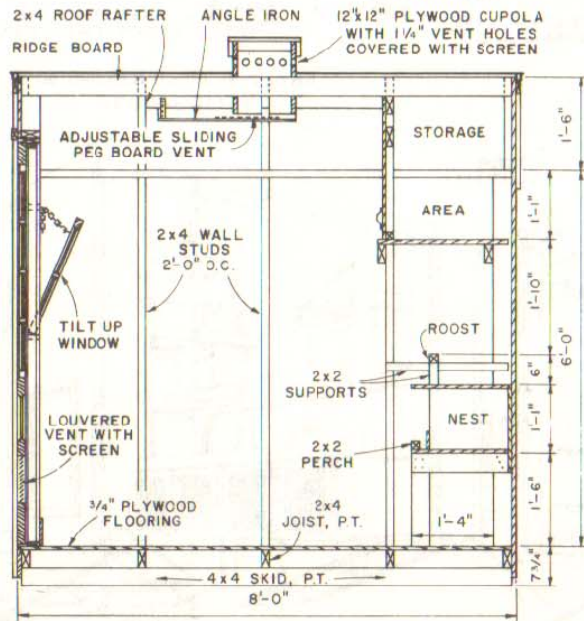

SECTION
LAYING HOUSE

NOTE:
P.T. = PRESSURE TREATED

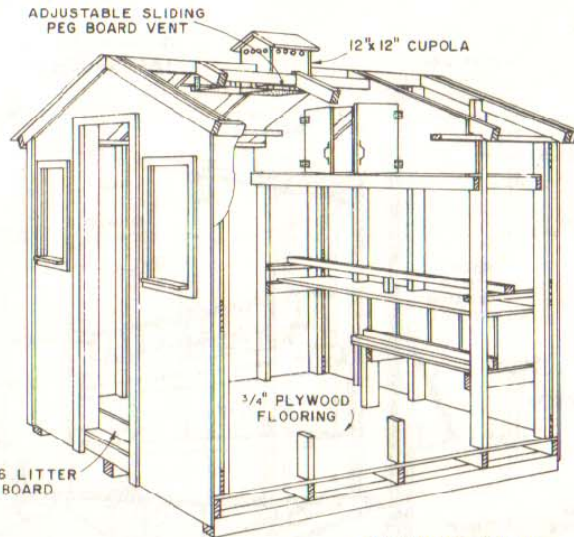

CUTAWAY VIEW
OF 8x8' LAYING HOUSE

NOTE:
CAPACITY 15-20 HENS
4-NESTS
ROOST & STORAGE AREAS.

NOTE:
BASED ON: UNIV. OF WISCONSIN
PLANS NO. WP 5702, 5703, 5704
AND 5705.
CONSULT LOCAL HEALTH AND
BUILDING CODE AUTHORITIES
BEFORE STARTING CONSTRUCTION.



COOPERATIVE EXTENSION WORK IN AGRICULTURE AND HOME ECONOMICS		
STATE OF TENNESSEE		
UNIVERSITY OF TENNESSEE		
AGRICULTURAL ENGINEERING DEPARTMENT AND UNITED STATES DEPARTMENT OF AGRICULTURE COOPERATING		
POULTRY & PIGEON HOUSES BROODERS-LAYERS-BANTAMS		
WISC '75	6232	SHEET 1 OF 2

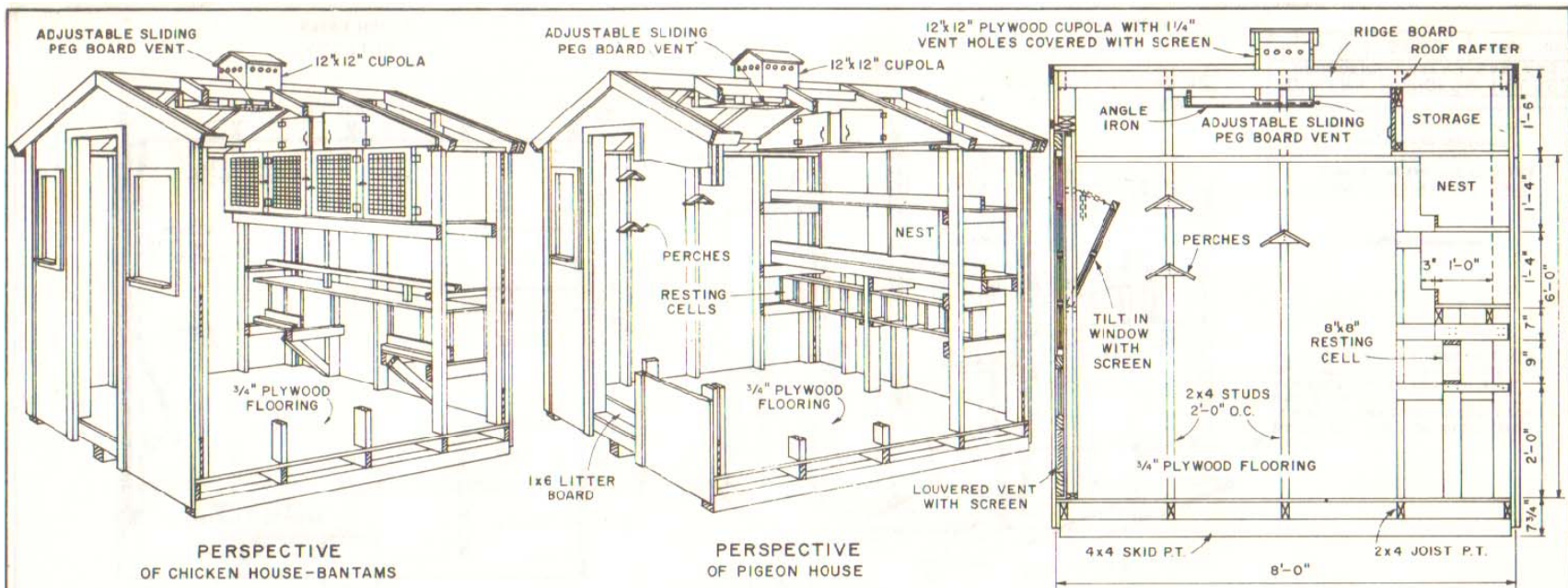

PERSPECTIVE OF CHICKEN HOUSE-BANTAMS

PERSPECTIVE OF PIGEON HOUSE

SECTION OF PIGEON HOUSE

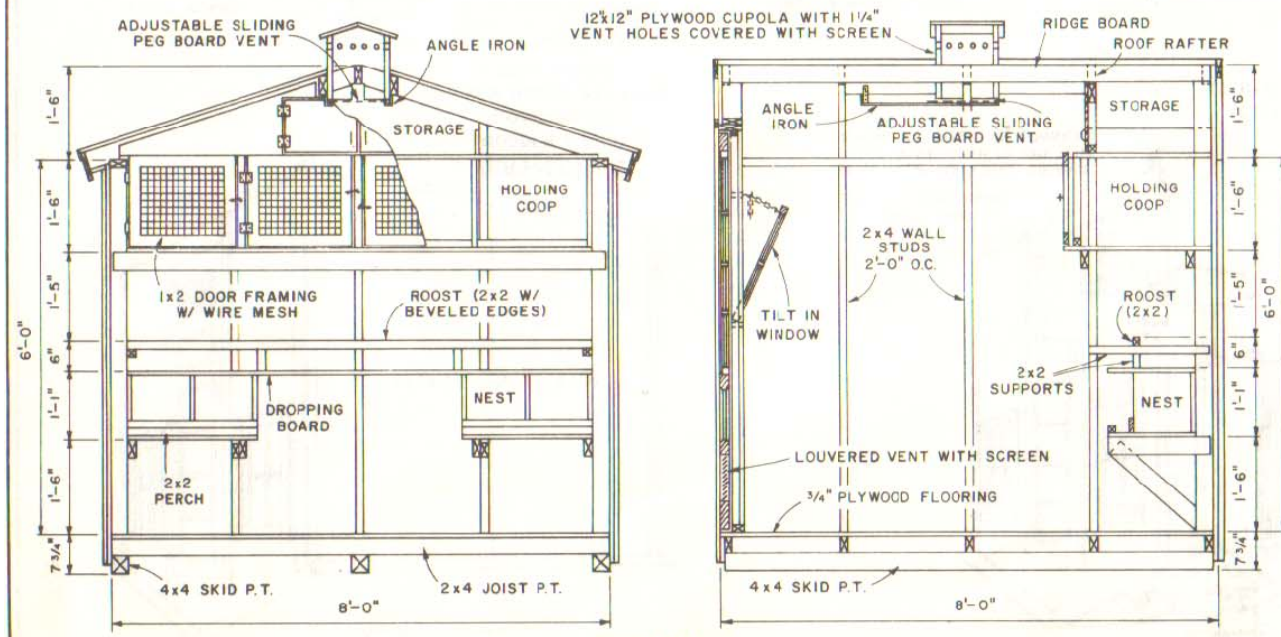

SECTIONS OF CHICKEN HOUSE-BANTAMS

NOTE: P.T. = PRESSURE TREATED.



COOPERATIVE EXTENSION WORK IN AGRICULTURE AND HOME ECONOMICS
 STATE OF TENNESSEE
 UNIVERSITY OF TENNESSEE
 AGRICULTURAL ENGINEERING DEPARTMENT
 AND
 UNITED STATES DEPARTMENT OF AGRICULTURE COOPERATING

POULTRY & PIGEON HOUSES
BROODERS-LAYERS-BANTAMS

WISC. '75	6232	SHEET 2 OF 2
-----------	------	--------------